

COMMERCIAL
STAINLESS STEEL

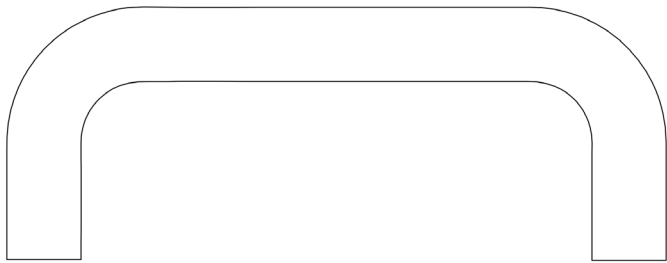

CODE

JSS119A

DESCRIPTION

D Shape Pull Handle

STANDARDS



PRODUCT SPECIFICATION

- M8 bolt fixing
- Suitable door thickness: 35-54mm
- Suitable glass door thickness: 8-10mm
- Corrosion grade 4

TECHNICAL DRAWING

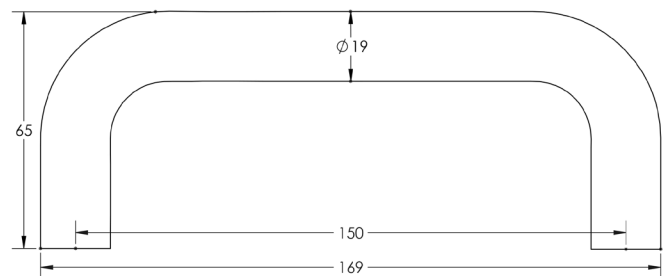

FINISHES

- Satin Stainless Steel