

GHOST

CONCEALED HINGES

CH60

FITTING INSTRUCTIONS

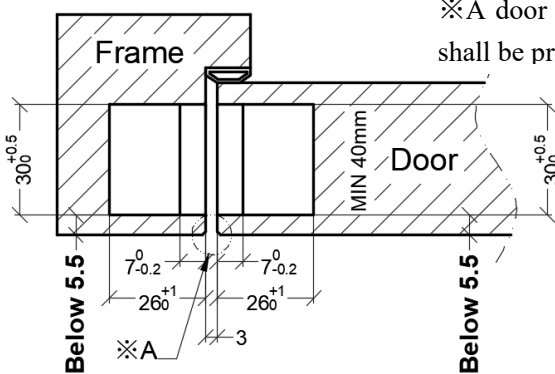
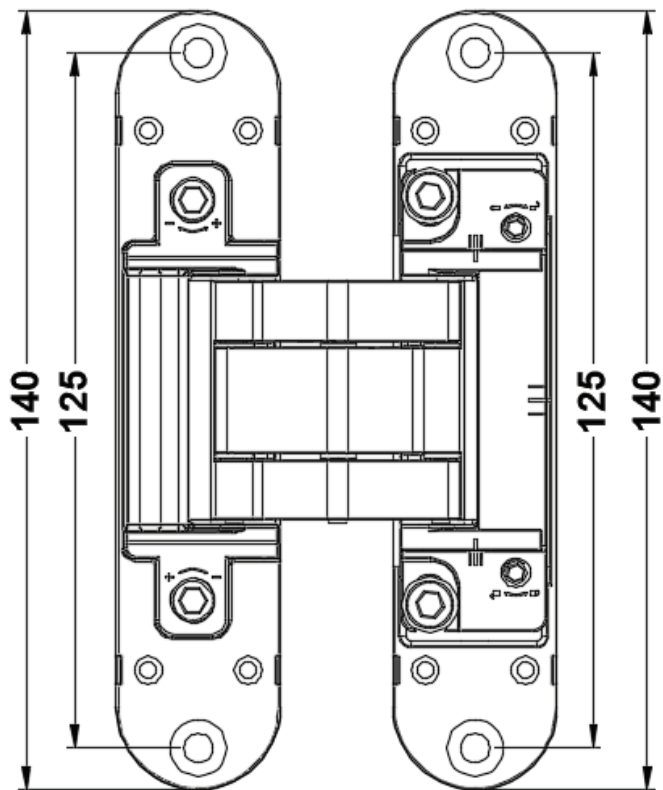
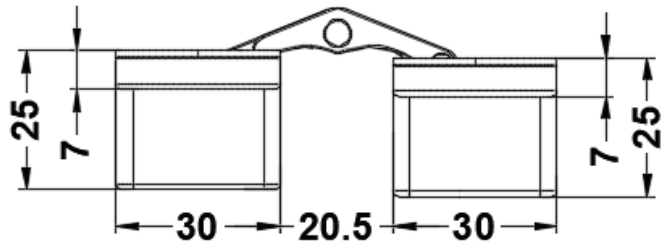
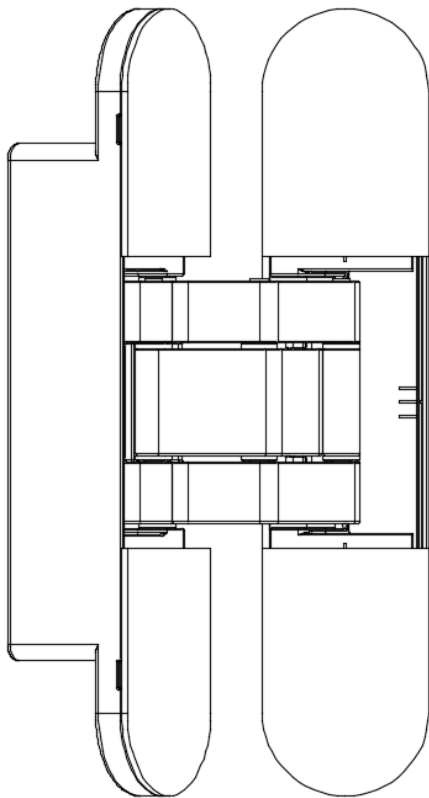

※A door leaf and door frame corners shall be processed by C1

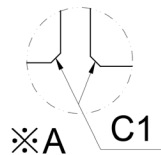

Maximum Weight
60KG

When using 3 hinges

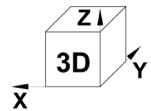

Left and right adjustment: $\pm 1.5\text{mm}$
Up and down adjustment: $\pm 2.5\text{mm}$
Front and rear adjustment: $\pm 1.0\text{mm}$

1

Slot the door leaf and frame as shown in the image below.

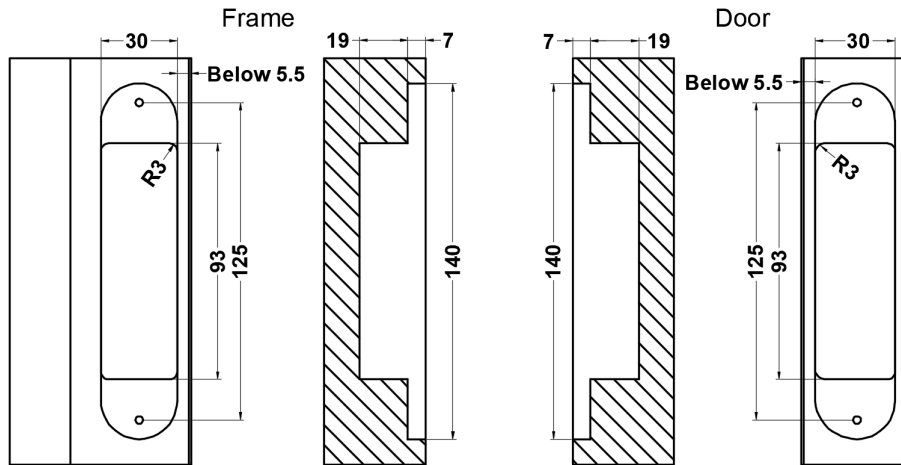

2

1. As figure ① shown install the side marked “Door” in the hole of the door leaf, Use a Phillips screwdriver to place the product into the inside door leaf;
2. As figure ② shown install the corresponding position of the door leaf with the product in the door frame with a hole, and tightened with Phillips screwdriver.
3. After the installation and commissioning, ensure the hinge is firm and stable. The hinge surface should be flush with the side of the door leaf and frame.

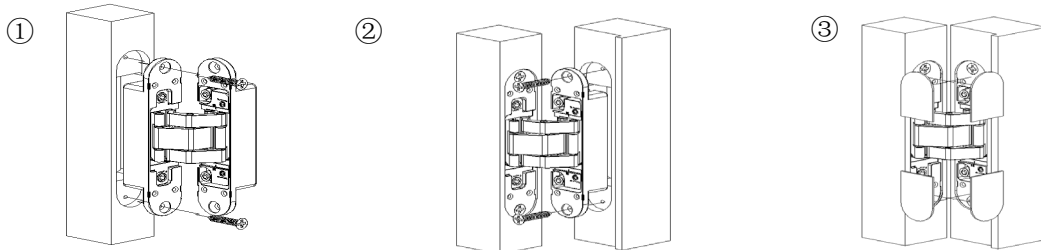

4. Repeatedly operate the door leaf to open and close many times, check that everything is in order for the customer to use.
5. Pay attention the hinge daily maintenance, keep it clean, meanwhile can be applied with the small amount of grease (oil).

3

Installation and adjustment function:

Left and right adjustment: Use Allen key to match A/A'. Clockwise adjust will increase the door gap, counterclockwise adjust will decrease the door. (Note: adjustment must be Synchronized!)

Front and rear adjustment: Loosen the B/B' screw counterclockwise to adjust it and then drop lock;

Up and down adjustment: Loosen the C/C' Screw counterclockwise to adjust it and the n drop lock.

