

### BURLINGTON RANGE

#### CODE

BUR910

#### DESCRIPTION

Angle Hook Edge Pull - 50mm

#### STANDARDS

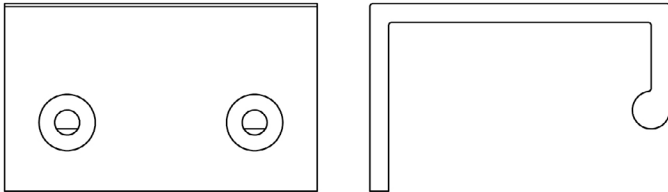

### PRODUCT SPECIFICATION

- Solid brass
- M4 screws included
- Grade 4 corrosion
- Available in:
  - 150mm - BUR911
  - 300mm - BUR912
- *We strongly recommend requesting a sample before committing to any cutting or drilling*

### TECHNICAL DRAWING

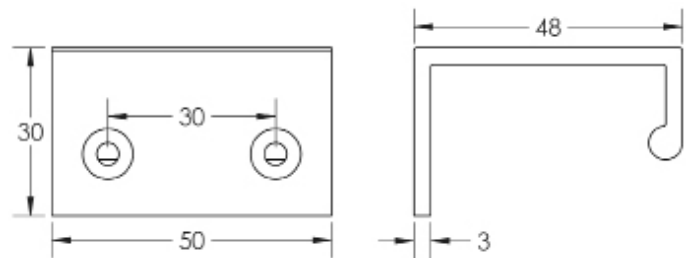

### FINISHES

- Antique Brass
- Dark Bronze
- Polished Nickel
- Satin Brass
- Satin Nickel